



HARROW SCHOOL
ENTERPRISES

EVENTS

THE ALEX FITCH ROOM

SEATING PLAN & ROOM LAYOUTS



THE ALEX FITCH ROOM

The Alex Fitch Room is the most poignant room at Harrow School. Located in the War Memorial Building, the entire contents of the room were donated by the Fitch family in memory of their son, who died in the First World War. His portrait is hung above the fireplace and the light above it is never put out in respect for the fallen. All proceeds from the hire of this room go towards a bursary for a boy to attend Harrow.



EXISTING FURNITURE & DIMENSIONS

Dimensions

14.1m x 6.1m

Due to the nature of the room, all furniture in the Alex Fitch Room must stay in position for any event. The room itself includes panelling from the Elizabethan period with the fireplace dating from the reign of Henry V. The floor is made of decking from H.M.S. Vincent, which served during the reign of George III. The furniture to the exterior of the room is from the reign of James I, as is the main dining table.

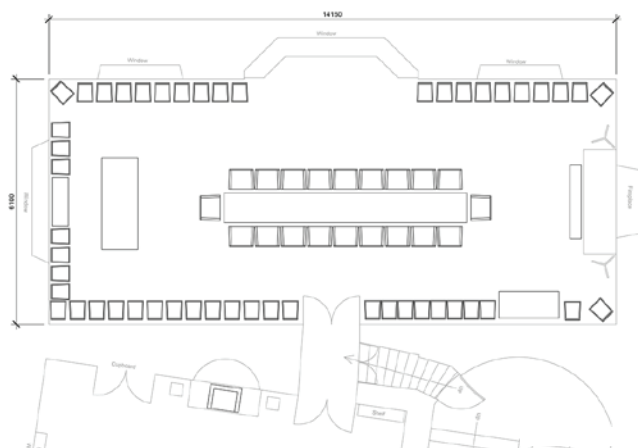

DINNER LAYOUT

Capacity

20

Tables

1

Chairs per table

20

Table dimensions

Existing

Up to 20 guests can dine in this grand room, for the most exclusive of dinners. Using the central table, diners are surrounded by historical objects which can be enhanced through floral arrangements and sympathetic lighting. Due to the age of the table, this must be fully protected by one of our nominated suppliers. Guests can also have a pre-reception in the adjacent Old Harrovian Room.

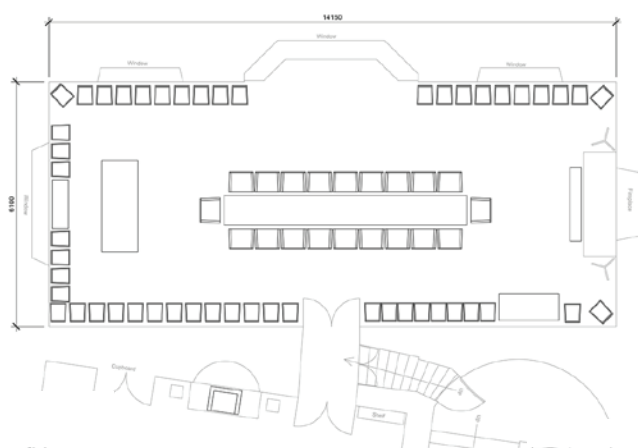

UNIQUELY HARROW & EXCLUSIVELY YOURS

5 High Street, Harrow on the Hill, Middlesex, HA1 3HP

E enterprises@harrow.school.org.uk W harrow.school enterprises.com

T 020 8426 4638 @HarrowSchoolEnt

WEDDINGS | RECEPTIONS | PARTIES | DINNERS | PERFORMANCES | CORPORATE EVENTS